

Smalewell Rd, Pudsey, Leeds, West Yorkshire, LS28 8JH

£350,000

Council Tax Band: C



Open House Estate Agents South Leeds are proud to bring to the market this Charming 3 Bedroom Semi-Detached home with some lovely Rustic Features, located within walking distance to the Picturesque Countryside Walks in Black Carr Woods & Pudsey Park.

This property is Beautifully presented, with an extended Kitchen & Dining Area with Wooden Beams & Exposed Brick Features, a Utility area and Further side extension with Boot room & Store, Lounge Living Area with Media Wall Feature, Three Good sized Bedrooms, complimented with a Contemporary & Country Style Family Bathroom.

Outside, the property has not one, but TWO rear Gardens, the larger of which is completely private & secluded, with its own seating & decking area. Alongside the larger Garden at the utmost rear is a Garage with Off street Parking/Driveway for up to 2 vehicles.

This beautiful dwelling would suit the Outdoorsy types who are looking for a good sized home within walking distance of Countryside walks, as well as all the amenities you could ask for, Great Local Pubs and Schools, which are all 'Good' Ofsted rated.



Open House Huddersfield

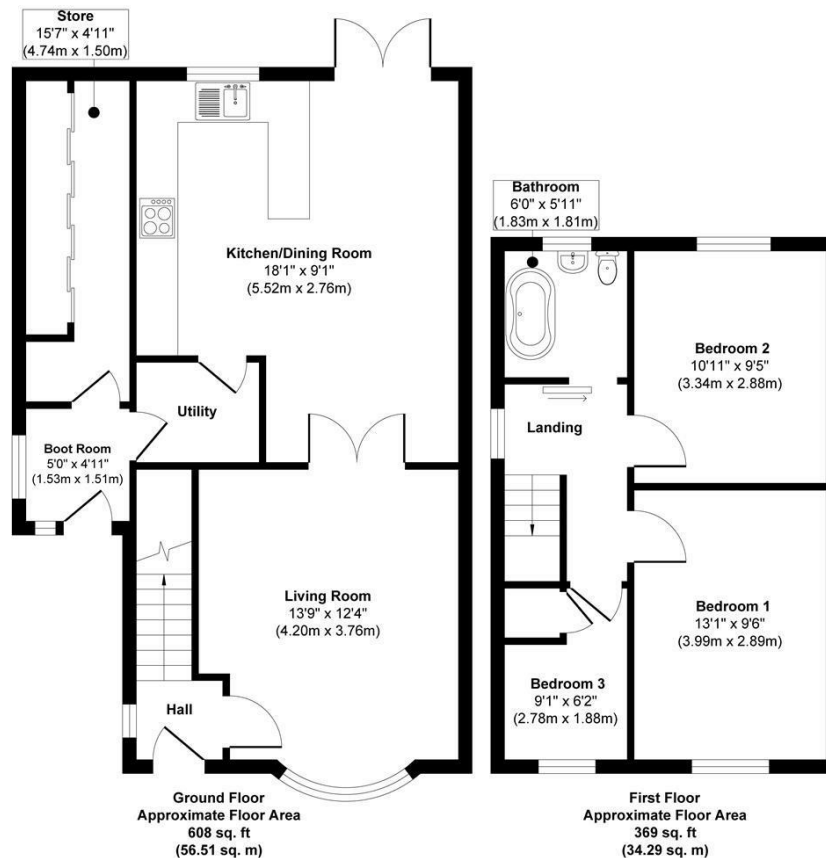

Approx. Gross Internal Floor Area 977 sq. ft / 90.80 sq. m

Illustration for identification purposes only, measurements are approximate, not to scale.

Produced by Elements Property

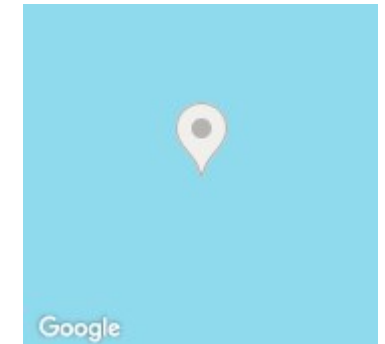

Energy Efficiency Rating		Current	Potential
Very energy efficient - lower running costs			
(92 plus)	A		
(81-91)	B		
(69-80)	C		
(55-68)	D	69	77
(39-54)	E		
(21-38)	F		
(1-20)	G		
Not energy efficient - higher running costs			
England & Wales		EU Directive 2002/91/EC	